

69

Route Guide & Hazard Awareness

**WALTHAMSTOW CENTRAL - HOE STREET - LEYTON STATION
STRATFORD - WEST HAM LANE - PLAISTOW - CANNING TOWN**



Photo | *Kristian Lake*

CONTENTS

FULL ROUTE 69 MAP

Between
Walthamstow
and Leyton.

3

FULL ROUTE 69 MAP

Between Leyton
and Plaistow.

4

FULL ROUTE 69 MAP

Between Plaistow
and Canning
Town Bus Station.

5

RUNNING LIGHT

To and from
Canning Town
Bus Station.

6

RUNNING LIGHT

To and from
Walthamstow Bus
Station.

7

IN SERVICE

Route guide
from
Walthamstow to
Canning Town
Bus Station.

8

IN SERVICE

Route guide
from Canning
Town Bus Station
to Walthamstow.

9

WALTHAMSTOW CENTRAL

Terminus point
and map.

10

LEYTON, BAKERS ARMS

Turning point
and map.

11

LEYTON, GRANGE PARK ROAD

Curtaiment
point and map.

12

LEYTON, DOWSELL ROAD

Curtaiment point
and map.

13

STRATFORD BUS STATION

Curtaiment point
and map.

14

PLAISTOW, BULL ROAD

Turning point
and map.

15

CANNING TOWN, HERMIT ROAD

Turning point
and map.

16

CANNING TOWN BUS STATION

Terminus point
and map.

17

LOCAL HAZARDS

Hazards to be
aware of and
other points to
note.

18

LOCAL HAZARDS

Hazards to be
aware of and
other points to
note.

19

LOCAL HAZARDS

Hazards to be
aware of and
other points to
note.

20

AT THE GARAGE

General
information and
safety at the
garage.

21

CODES & PROCEDURES

Curtaiment abrv
& emergency radio
procedure.

22

THINGS TO REMEMBER

Make notes along
the way.

23

THINGS TO REMEMBER

Make notes
along the way.

24

THINGS TO REMEMBER

Make notes along
the way.

25

LOW BRIDGE

Manor Road, off
line of route in
West Ham.

26

ROUTE 69 MAP

WALTHAMSTOW AND LEYTON

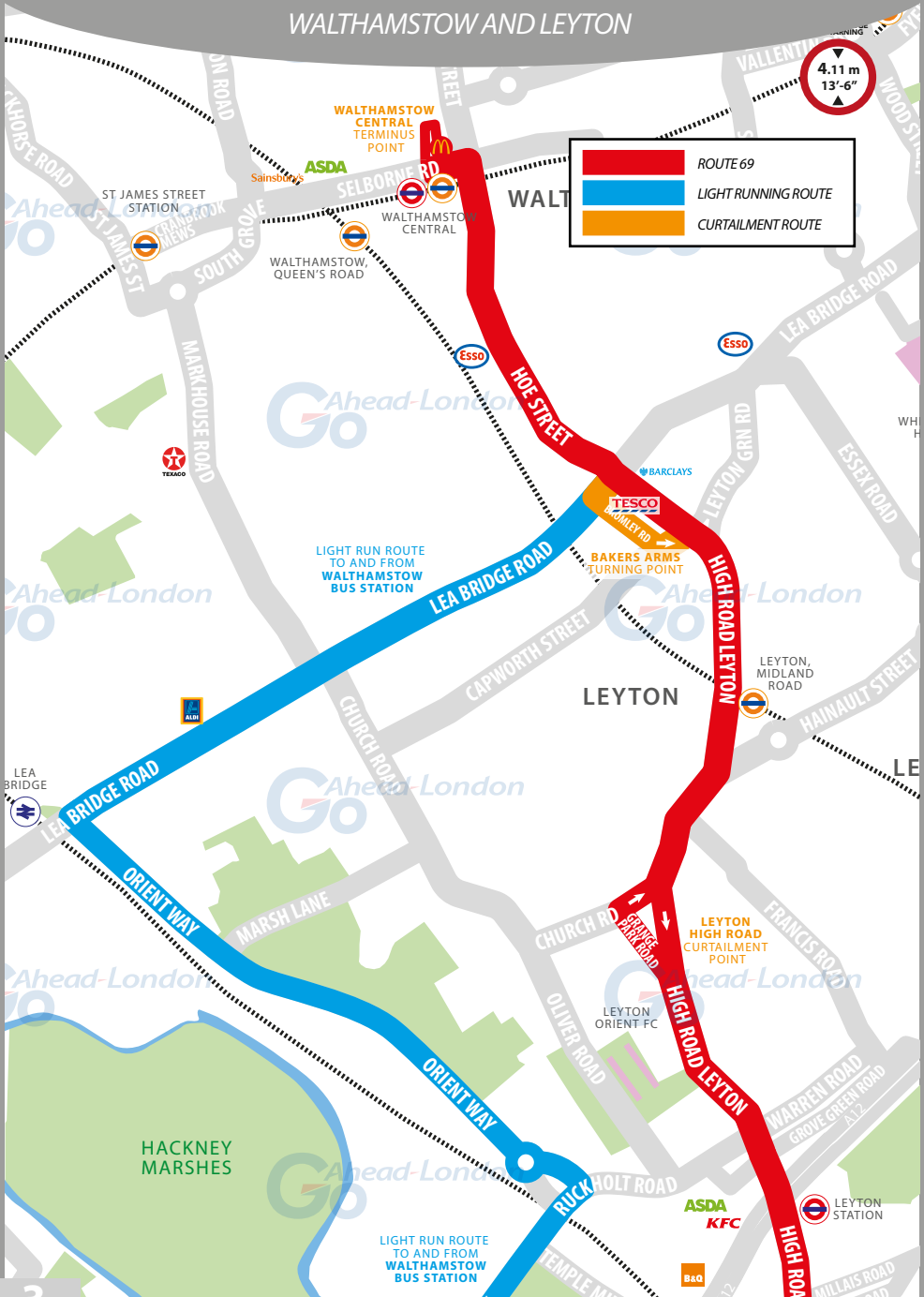

ROUTE 69 MAP

LEYTON AND PLAISTOW



ROUTE 69 MAP

PLAISTOW AND STRATFORD BUS STATION



RUNNING LIGHT

RUNNING OUT OF SERVICE

IMPORTANT
LOG OFF IBUS
IMMEDIATELY
IF RUNNING
LIGHT

TO CANNING TOWN BUS STATION

- From **Silvertown garage**, turn left onto Factory Road
- Follow road right onto North Woolwich Road
- At roundabout, take 2nd exit onto North Woolwich Road (*past Pontoon Dock*)
- Continue over Silvertown Way overpass **A1011**
- Turn left into Stratford Bus Station to **stand**

FROM CANNING TOWN BUS STATION

- Exit **bus station** at traffic light, turn right onto Silvertown Way **A1011**
- Continue ahead on Silvertown Way (onto overpass) **A1011**
- Continue ahead on North Woolwich Road **A1020**
- At roundabout, take 2nd exit onto North Woolwich Road
- Follow the road left onto Factory Road to **Silvertown garage**

RUNNING LIGHT

RUNNING OUT OF SERVICE

IMPORTANT
LOG OFF IBUS
IMMEDIATELY
IF RUNNING
LIGHT

TO WALTHAMSTOW BUS STATION

- From **Henley Road garage**, turn left onto Factory Road
- Follow road right onto North Woolwich Road
- At roundabout, take 2nd exit onto North Woolwich Rd (*past West Silvertown*)
- Take slip road off Silvertown Way (*towards Isle of Dogs*) **A1011**
- At roundabout, take 2nd exit onto Lower Lea Crossing **A1020**
- At 2nd roundabout, take 4th exit onto Leamouth Road **A1020**
- At traffic light, turn left onto East India Dock Road **A13**
- At traffic light, turn right onto St. Leonards Road (*A12 towards Stratford*) **A13**
- Continue ahead onto Blackwall Tunnel Northern Approach **A12**
- Continue ahead onto East Cross Rte and take slip road (*towards Leyton A106*)
- At traffic light, continue ahead onto Eastway and Ruckholt Road **A106**
- At traffic light, turn left onto Orient Way (*towards Argall Road Ind Est*) **A13**
- At roundabout, take 3rd exit onto Orient Way
- At traffic light, turn right onto Lea Bridge Road **A104**
- At traffic light, turn left onto Hoe Street (*follow line-of-route*) to **stand**

FROM WALTHAMSTOW BUS STATION

- At **Walthamstow Bus Station**, continue line of route to Hoe Street **A112**
- At traffic light, turn right onto Lea Bridge Road **A104**
- At traffic light, turn left onto Orient Way (*towards Argall Road Ind Est*)
- At roundabout, take 2nd exit onto Orient Way
- At traffic light, turn right onto Ruckholt Road and Eastway **A106**
- At traffic light, turn right onto East Cross Rte **A12**
- Continue ahead onto Blackwall Tunnel Northern Approach **A12**
- Turn left onto Abbott Road B125
- At traffic light, turn left onto East India Dock Rd (*towards Canning Town*) **A13**
- At traffic light, turn right onto Silvertown Way (*under A13 overpass*) A1011
- Continue ahead on Silvertown Way (*onto overpass*) **A1011**
- Continue ahead on North Woolwich Road **A1020**
- At roundabout, take 2nd exit onto North Woolwich Rd and onto Factory Rd
- At junction, turn right onto Store Road and Pier Road (one-way street)
- Follow road to the right onto Henley Road to **Henley Road garage**

ROUTE DIRECTIONS

RUNNING IN SERVICE

NEVER
DIVERT OFF
LINE-OF-ROUTE
UNLESS ADVISED
BY IBUS

TO CANNING TOWN BUS STATION

- From **stand**, continue ahead to exit Walthamstow Bus Station
- At traffic light, turn left onto Selborne Road
- At traffic light, turn right onto Hoe Street **A112**
- At traffic light, continue ahead onto High Road Leyton **A112**
- Continue ahead onto High Road Leyton (*past Leyton Midland Rd Station*) **A112**
- Continue ahead onto High Road Leyton (*onto one-way system*) **A112**
- Continue ahead onto High Road Leyton (*over A12, past Leyton Station*) **A112**
- At traffic light, turn left onto Crownfield Road
- At traffic light, turn right onto High Road Leytonstone
- Continue ahead onto Leytonstone Road
- At Maryland one-way system, take 2nd exit onto Leytonstone Road
- Follow road to the left onto The Grove
- Continue ahead onto The Grove (*onto one-way system*) **A118**
- At traffic light, turn right onto Broadway **A118**
- At traffic light, turn left onto Tramway Avenue **A112**
- Continue ahead onto West Ham Lane **A112**
- Continue ahead onto New Plaistow Road **A112**
- Continue ahead onto Plaistow Road (*past Plaistow Station*) **A112**
- At traffic light, turn right onto Upper Road
- Follow road to the right onto Grange Road
- Continue ahead onto Hermit Road
- At traffic light, turn right onto Barking Road (*McDonald's ahead*) **A124**
- Follow road under A12 overpass towards bus station road
- Turn left onto bus station road to Canning Town bus station to **stand**

ROUTE DIRECTIONS

RUNNING IN SERVICE

**NEVER
DIVERT OFF
LINE-OF-ROUTE
UNLESS ADVISED
BY IBUS**

TO WALTHAMSTOW BUS STATION

- From **stand**, continue ahead and exit Canning Town bus station
- Follow road under A12 overpass towards Barking
- Take 2nd exit (under overpass) onto Barking Road **A124**
- At traffic light, turn left onto Hermit Road (*McDonald's on the right*)
- Continue ahead onto Grange Road
- Follow road to the left onto Upper Road
- At traffic light, turn left onto Plaistow Road (*past Plaistow Station*) **A112**
- Continue ahead onto New Plaistow Road **A112**
- Continue ahead onto West Ham Lane **A112**
- Continue ahead onto Tramway Avenue **A112**
- At traffic light, turn left onto Broadway **A118**
- At traffic light, turn right onto Great Eastern Road (*onto one-way system*) **A118**
- At traffic light, turn left onto The Grove
- Follow road to the right onto Leytonstone Road (*Maryland station*)
- At Maryland one-way system, take 1st exit onto Leytonstone Road
- Continue ahead onto High Road Leytonstone
- At traffic light, turn left onto Crownfield Road
- At traffic light, turn right onto High Road Leyton **A118**
- Continue ahead onto High Road Leyton (*over A12, past Leyton Station*) **A112**
- Continue ahead onto Grange Park Road (*one-way system*) **A112**
- Follow road to the right onto Church Road (*one-way system*) **A112**
- At traffic light, turn left onto High Road Leyton **A112**
- Continue ahead onto High Road Leyton (*past Leyton Midland Rd Station*) **A112**
- At traffic light, continue ahead onto Hoe Street **A112**
- At traffic light, turn left onto Selborne Road
- At traffic light, turn right into Walthamstow Bus Station to **stand**

WALTHAMSTOW CENTRAL

TERMINUS POINT

IMPORTANT
IF YOU REQUIRE A
COMFORT BREAK,
PLEASE ADVISE
IBUS

From Canning Town. Proceed from Walthamstow Central Bus Station direct to stand.

Set down in Walthamstow Central Bus Station at **ALIGHTING POINT**.

Towards Canning Town. Depart to Walthamstow Central Bus Station.

Pick up in Walthamstow Central Bus Station at **BUS STOP A**.

Private stand for 13 buses in marked bays on east side of Walthamstow Central Bus Station on north side of Selborne Road. Overflow offside stand for 1 bus on west side of bus station in lay-by opposite Stop A.

Blind display: **WALTHAMSTOW CENTRAL**.



LEYTON

TURNING POINT

IMPORTANT
IF YOU REQUIRE A
COMFORT BREAK,
PLEASE ADVISE
IBUS

From Canning Town. Proceed from High Road Leyton via Lea Bridge Road, Bromley Road and Capworth Street. Set down on High Road Leyton at **BUS STOP ND**.

Towards Canning Town. Depart to High Road Leyton. Pick up on High Road Leyton at **BUS STOP SM**.

Turning point only - buses must not stand.

Blind display: LEYTON, BAKER ARMS.



LEYTON

CURTAILMENT POINT

TURNING POINT ONLY.
BUSES MUST NOT STAND.

From Canning Town. Proceed from High Road Leyton via Grange Park Road, Church Road and High Road Leyton to stand.
Set down on High Road Leyton at **BUS STOP N.**

Towards Canning Town. Depart to High Road Leyton.
Pick up on High Road Leyton at **BUS STOP P.**

Public stand for two buses on east side of Leyton High Road.

Blind display: LEYTON, GRANGE PARK ROAD.



**GRANGE
PARK ROAD**

LEYTON

CURTAILMENT POINT

SWITCH THE
ENGINE OFF
WHILST AT THE
STAND

From Canning Town. Proceed from High Road Leyton via Private Bus Stand Grounds to stand. Set down on High Road Leyton at **BUS STOP N**.

Towards Canning Town. Depart via Private Bus Stand Grounds to High Road Leyton. Pick up on High Road Leyton at **BUS STOP G**.

From Walthamstow. Proceed from High Road Leyton via Private Bus Stand Grounds to stand. Set down on High Road Leyton at **BUS STOP F**.

Towards Walthamstow. Depart via Private Bus Stand Grounds to High Road Leyton. Pick up on High Road Leyton at **BUS STOP P**.

Private stand for three buses on LT property on west side of Leyton High Road.

Blind display: **LEYTON, DOWNSSELL ROAD.**

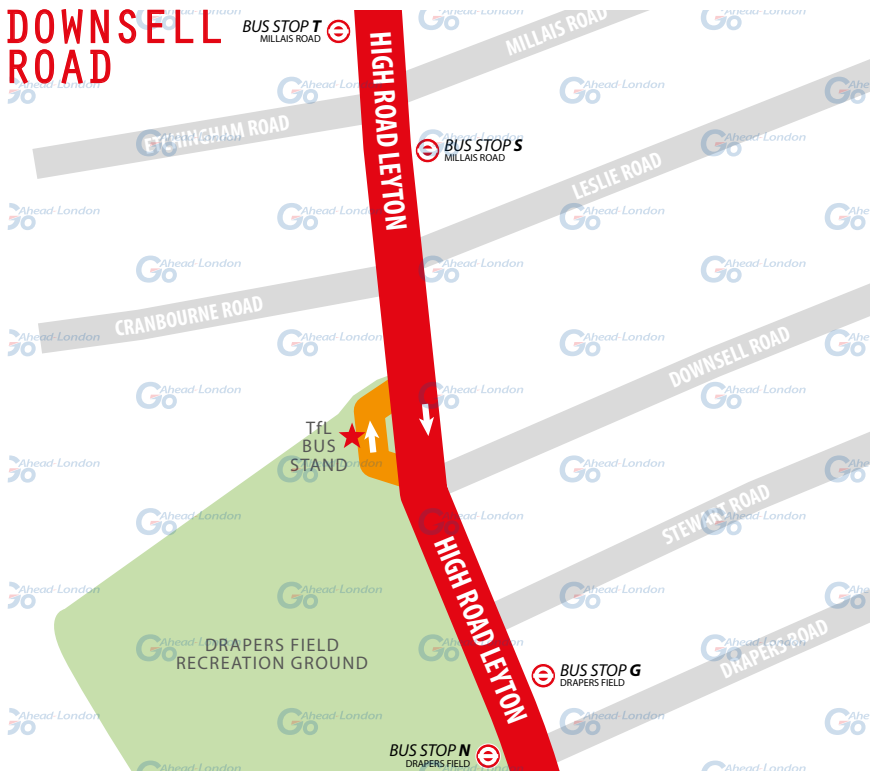

STRATFORD BUS STATION

CURTAILMENT POINT

IMPORTANT
IF YOU REQUIRE A
COMFORT BREAK,
PLEASE ADVISE
IBUS

From Canning Town. Proceed from Great Eastern Road via Station Street, Stratford Bus Station and Stratford Bus Station to stand. Set down on Station Street at **ALIGHTING POINT**.

Towards Canning Town. Depart via Stratford Bus Station, Stratford Bus Station and Great Eastern Road to The Grove. Pick up on The Grove at **BUS STOP R**.

From Walthamstow. Proceed from The Grove via Broadway, Great Eastern Road, Station Street, Stratford Bus Station and Stratford Bus Station to stand. Set down on The Grove at **BUS STOP R**.

Towards Walthamstow. Depart via Stratford Bus Station and Stratford Bus Station to Great Eastern Road. Pick up on Great Eastern Road at **BUS STOP P**.

Private stand for up to 14 buses facing north in Stratford Bus Station on west side of Great Eastern Road. **Blind display:** **STRATFORD**.

BUS STATION

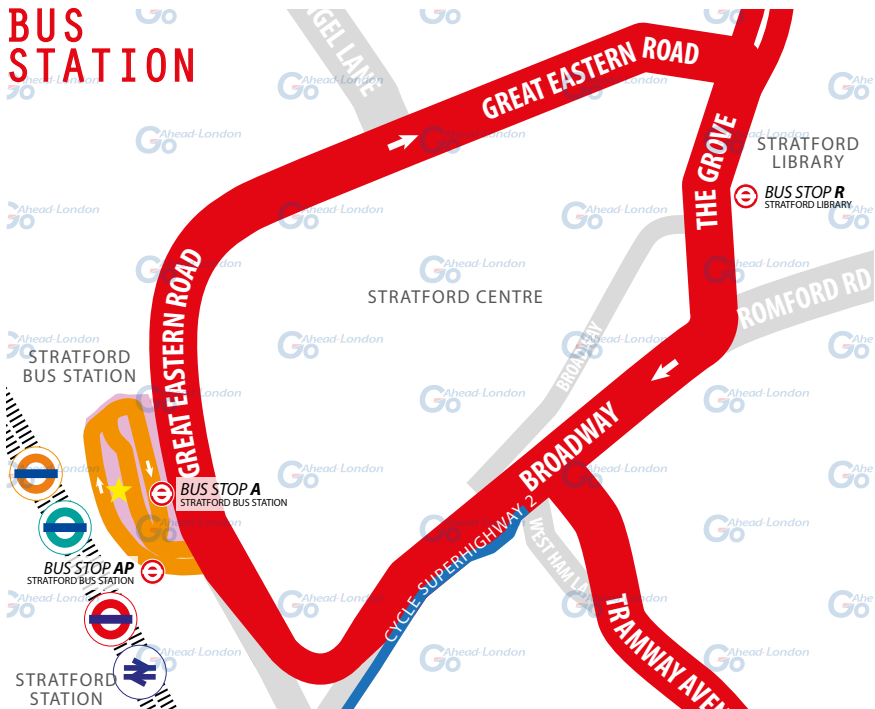

PLAISTOW

TURNING POINT

TURNING POINT ONLY.
BUSES MUST NOT STAND.

From Walthamstow. Proceed from Plaistow Road via Bull Road, Willis Road and Holbrook Road. Set down on Plaistow Road at **BUS STOP M**.

Towards Walthamstow. Depart to Plaistow Road.
Pick up on Plaistow Road at **BUS STOP L**.

Turning point only - buses must not stand.

Blind display: **PLAISTOW.**

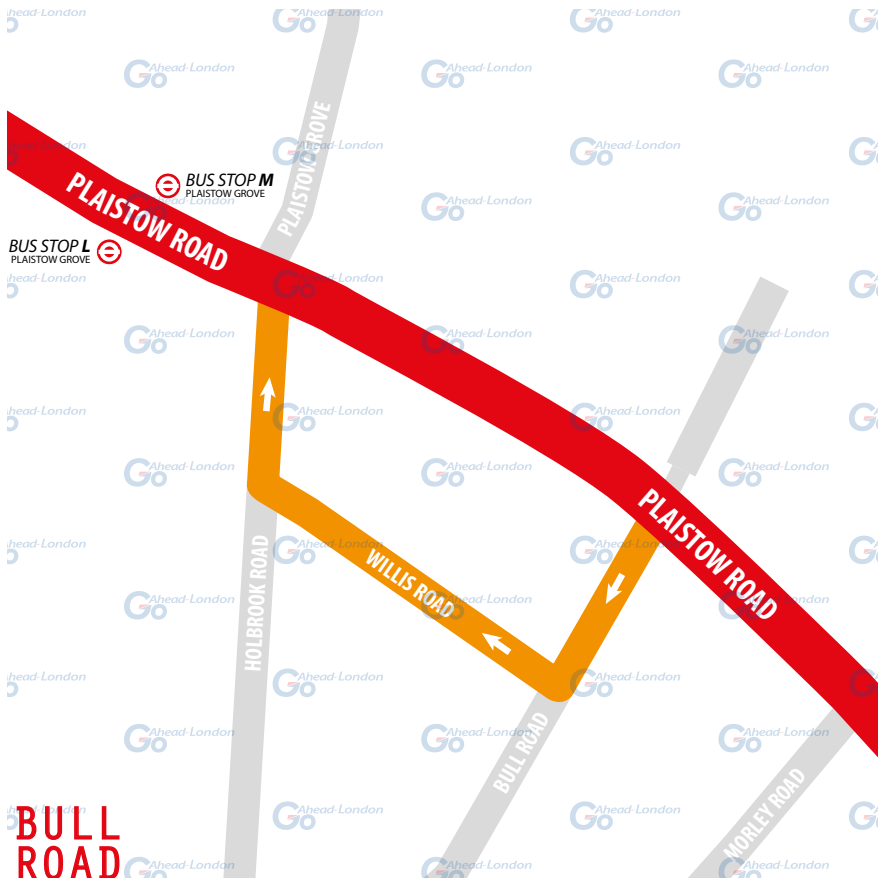

CANNING TOWN

TURNING POINT

TURNING POINT ONLY.
BUSES MUST NOT STAND.

From Walthamstow. Proceed from Hermit Road via Beckton Road, Bernard Cassidy Street, Morgan Street and Barking Road. Set down on Hermit Road at **BUS STOP U**.

Towards Walthamstow. Depart to Hermit Road. Pick up on Hermit Road at **BUS STOP T**.

Turning point only - buses must not stand.
Blind display: **CANNING TOWN, HERMIT ROAD.**

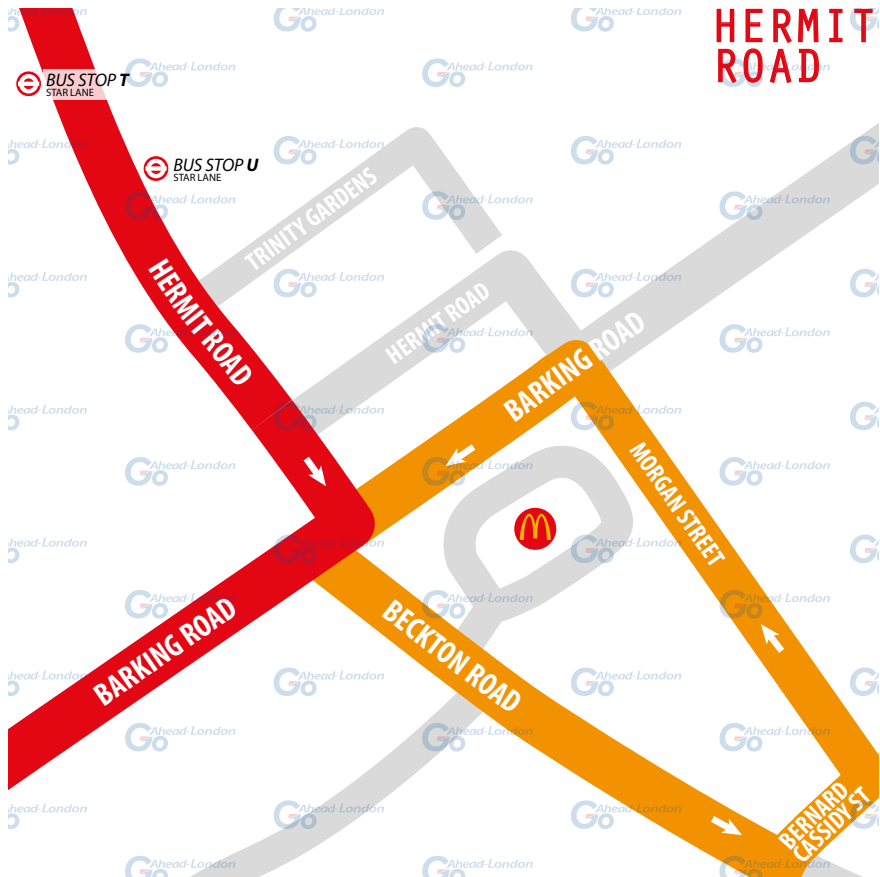

CANNING TOWN

TERMINUS POINT

PLEASE CHECK
TRIP NUMBER
ON ETM BEFORE
DEPARTING

From Walthamstow. Proceed from Canning Town Bus Station direct to stand. Set down in Canning Town Bus Station at **BUS STOP A**.

Towards Walthamstow. Depart to Canning Town Bus Station. Pick up in Canning Town Bus Station at **BUS STOP E**.

Private stand for 2 buses in marked bays at rear stand on west side of Canning Town Bus Station at south-west corner of junction of Barking Road and Silvertown Way. **Blind display:** **CANNING TOWN**.

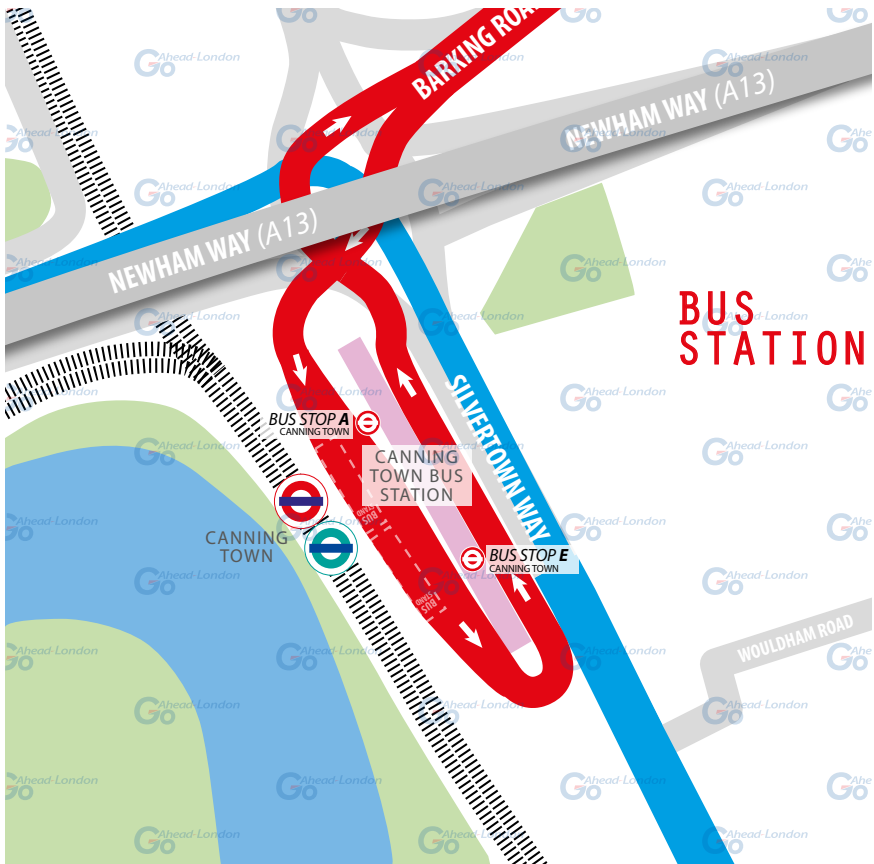

LOCAL HAZARDS & POINTS TO NOTE

FULL RISK ASSESSMENT VIEWABLE UPON REQUEST



VARIOUS HAZARDS | CANNING TOWN BUS STATION

Space for two buses to be parked on the offside. Risk of buses driving past. Drivers stepping off. Speed limit 10 mph. Approach parked buses with caution and take care when alighting as a high bus movement area. Hi vis jackets to be worn at all times whilst walking around the bus station.

BUSY BUS STOP | CANNING TOWN BUS STATION

Drivers are required to look/wait for intending passengers. Ensure the doors are clear before closing and moving off.

BUSY PEDESTRIAN AREA | CANNING TOWN BUS STATION

Danger of people stepping out without looking. Drivers need to exercise and caution and be on the lookout for pedestrians walking out in front of buses.

LOW BRIDGE | MANOR ROAD

Do not use Manor Road under any circumstances. There is a low bridge further along this road. Not suitable for double deck buses.

BOX JUNCTION | BARKING ROAD

Box junction on approach to Canning Town Bus Station. Drivers are advised that this junction box is live. Ensure that the whole bus can clear the junction.

BUSY BUS STOP | BARKING ROAD

Driver are required to look/wait for intending passengers. Ensure the doors are clear before closing and moving off.

TIGHT LEFT TURN | HERMIT ROAD

Tight left turn especially if vehicles go over the stop line. Exercise caution as vehicle regularly goes over the stop line.

BUS STAND | HERMIT ROAD CURTAILMENT

Drivers are reminded that the stand for Hermit Road is behind the McDonalds and must not use the 474 stand.

NARROW ROAD | HERMIT ROAD

Due to parked cars on either side, buses travel in both direction. Read road and plan. Work with large vehicles/buses heading in the opposite way.

LOCAL HAZARDS & POINTS TO NOTE

FULL RISK ASSESSMENT VIEWABLE UPON REQUEST



BLIND BEND | GRANGE ROAD / UPPER ROAD

Drivers advised to use extreme caution as buses use both directions.

NARROW ROAD | UPPER ROAD

Narrow road due to parked cars on either side, Exercise care and caution.

TIGHT LEFT TURN | UPPER ROAD / PLAISTOW ROAD

Tight left turn from Upper Road onto Plaistow Road. Risk of clipping kerb. Drivers are advised the when turning left, risk of mounting kerb.

PEDESTRIANS CROSSING | PLAISTOW ROAD

Danger of people crossing from behind cars. Exercise caution and be on the lookout for pedestrians walking out in front of buses.

TRAFFIC ISLAND | MANOR ROAD

Risk of collision with traffic island if bus does not get in the right lane. Driver advised to get in lane early to avoid contact with high kerb.

LOW BRIDGE | NEW PLAISTOW ROAD

Do not use Manor Road under any circumstances. There is a low bridge further along this road. Not suitable for double deck buses.

PEDESTRIANS CROSSING | WEST HAM LANE

Danger of people crossing from behind cars. Driver needs to exercise caution and be on the lookout for pedestrians walking out in front of buses.

BUSY BUS STOP | TRAMWAY AVENUE

Risk of collision. Buses must merge into busy traffic. Care and caution when merging into main carriageway after serving bus stop especially during peak times.

BUSY PEDESTRIAN AREA | HIGH STREET

Pedestrians running across the junctions often without looking. Look/wait for intending passengers. Ensure the doors are clear before closing and moving off.

CYCLISTS | GREAT EASTERN ROAD

Very busy area with cycle lanes and cyclists. Risk of collision with cyclists and pedestrians. Care and caution and look out for cyclist merging for cycle lane.

LOCAL HAZARDS & POINTS TO NOTE

FULL RISK ASSESSMENT VIEWABLE UPON REQUEST



VARIOUS HAZARDS | BUS STATION (IF CURTAILED)

Offside parking on stand, risk of buses passing if you step off the bus or if you drive past a bus, a driver may step off. Approach parked buses with caution and take care when alighting in this high bus movement area. Hi vis jackets always to be worn whilst walking around the bus station.

NARROW ROAD | LEYTONSTONE RD/CROWNFIELD RD

Narrow road with cars parked. Risk of doors being opened and pedestrian crossing from behind parked vehicles. Drivers advised to exercise caution when driving through residential areas.

PEDESTRIANS CROSSING | HIGH ROAD LEYTON

Danger of people crossing from behind cars. Drivers need to exercise caution and be on the lookout for pedestrians walking out in front of buses.

LANE DISCIPLINE | CHURCH ROAD

Bus needs to merge with traffic on the right. Risk of collision during peak traffic times. Drivers advised to use care and caution when merging into main carriageway after serving bus stop especially during peak times.

BUS GARAGE | HIGH ROAD LEYTON / LEYTON GREEN RD

Leyton bus garage. Risk of road being blocked by buses returning to garage. Be aware of buses being parked, waiting to get into the bus garage.

NARROW ROAD | HIGH ROAD LEYTON / BAKERS ARMS

Bakers Arms curtailment. Drivers are advised that Bromley Road is a narrow road and exercise care when turning onto Capworth Street.

BUSY PEDESTRIAN AREA | HOE STREET

Danger of people crossing from behind cars. Driver needs to exercise caution and be on the lookout for pedestrians walking out in front of buses.

TIGHT LEFT TURN | WALTHAMSTOW CENTRAL BUS STN

Tight left turn when exiting the bus station into a contraflow bus lane. Take care when turning left into the contraflow and be aware that pedestrians may be looking the wrong way. Wear Hi Vis. 10 mph. Buses parked on offside.

FULL RRA VIEWABLE UPON REQUEST. EXPIRY DATE: 21-02-2023

AT THE GARAGE

GARAGE AND GENERAL SAFETY INFORMATION

BE VISIBLE
**WEAR YOUR
HI-VIS** WITHIN
THE GARAGE

GO SLOW!
MANDATORY
SPEED OF 5 MPH
WITHIN THE
GARAGE

BE NOTICED
HEADLIGHTS
ON AT ALL TIMES
IN THE GARAGE

STICK TO
DESIGNATED
PATHS AND
WALKWAYS

NO EXCUSES
PLEASE ABIDE BY
THE RULES. IT'S
MANDATORY!

BE AWARE.
REPORT ALL
HAZARDS
IMMEDIATELY

REMEMBER
**LOOK OUT
FOR CYCLISTS**
DRIVE SLOWLY

PARK FERRY
VEHICLES WITHIN
DESIGNATED
AREAS

**USE THE
HORN** WHEN
APPROACHING
CORNERS &
REVERSING

HYBRID BUSES
ARE SILENT. BE
EXTRA CAUTIOUS
WHILST ON THE
MOVE!

FUEL, OIL &
COOLANT SPILLS
CAN MAKE THE
SURFACE SLIPPERY
BE AWARE

FAMILIARISE
YOURSELF WITH
THE GARAGE
SAFETY CODE



AND THINK FIRST!

OTHER INFORMATION

CODES AND EMERGENCY RADIO PROCEDURES

REMAIN CALM:
GIVE ACCURATE
INFORMATION.
WE'RE HERE
TO ASSIST!

ROUTE 69 | CURTAILMENT ABBREVIATIONS:

WLTHC	Walthamstow Bus Station	BA	Leyton, Bakers Arms
GP	Leyton, Grange Park Road	DR	Leyton, Downsell Road
SBS	Stratford Bus Station	PHA	Plaistow, Bull Road
CHR	Canning Town, Hermit Road	CBS	Canning Town Bus Stn

CODE RED | EMERGENCY RADIO PROCEDURE

If you require the Emergency Services to attend your vehicle (for example in the event of passenger injury, assault or major RTA), you should contact CentreComm using the radio's Code Red facility. To call CentreComm, **hold down the Code Red button on your vehicle's radio for at least 3 seconds** until you hear a ringing tone to indicate that your call has been connected. Hold down the foot switch in the cab when you are speaking, and end what you have to say with the word "over" to indicate that you expect a response, or "over and out" if this is the end of your communication. Release the foot switch when you are not speaking. Remember to speak slowly and clearly. Note that you will usually receive a radio call from your depot shortly after you make a Code Red call. **You should not use the radio whilst the vehicle is in motion.**

CODE
GREEN

Call your garage for non-emergency, mechanical defects, help or advice

CODE
BLUE

Call CentreComm for non-emergency, incident reporting or diversions

CODE
RED

Call CentreComm for emergency services, passenger injury or assault

PLEASE REMEMBER.

NO REVERSING AT
WALTHAMSTOW
BUS STATION

WITHOUT A BANKSMAN, BSC OR WORK COLLEAGUE



Adhere to the speed limit within all bus stations and
always wear your **hi-vis** in a bus movement area.

BE AWARE.

WARNING LOW BRIDGE ON MANOR ROAD

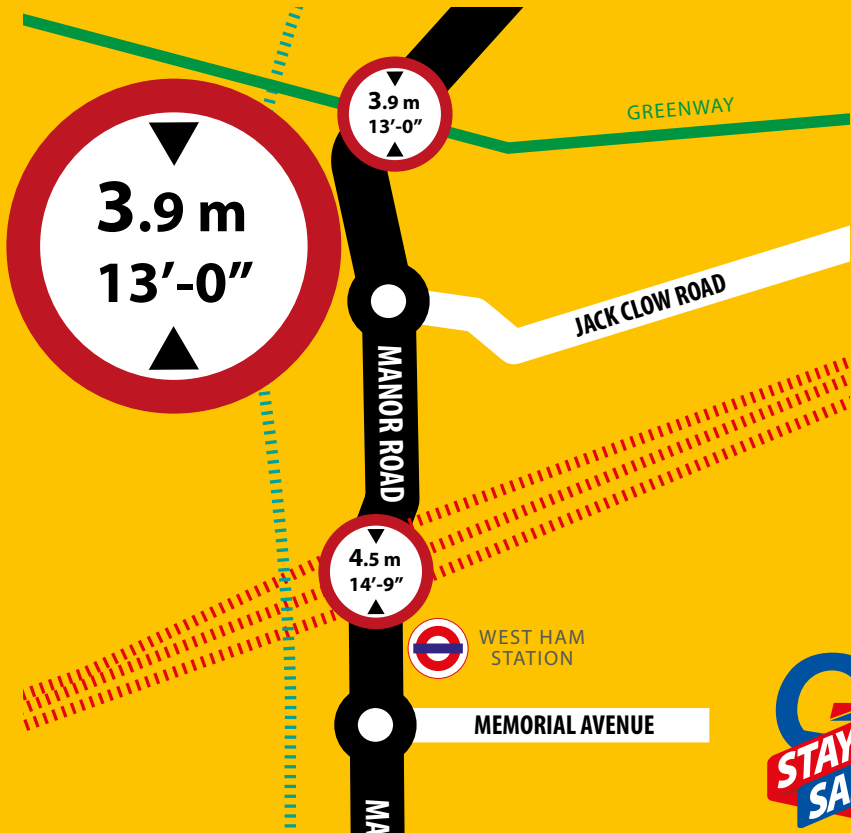

Warning. Low bridge on Manor Road (off line of route) in West Ham. **Do not go under this bridge** under any circumstances. Anticipate and always remain alert.